

# PLAT OF SURVEY

A PARCEL OF LAND SITUATED IN THE SOUTHEAST QUARTER OF SECTION 17, TOWN 7 NORTH, RANGE 2 EAST, SUPERIOR TOWNSHIP, WILLIAMS COUNTY, OHIO. LOCATED WITHIN THE NORTH AND THE EAST OF THE FIRST PRINCIPAL MERIDIAN OF THE ORIGINAL LAND SUBDIVISIONS OF OHIO.

COUNTY ROAD 8-50  
WEST LINE, SE 1/4, SECTION 17

NW CORNER, S 1/2,  
SE 1/4, SECTION 17

NE COR, SE 1/4,  
SECTION 17

Re-established at midpoint of East  
line of Section 17 per Vol 25R PG  
319. Could not locate iron pin set  
by Lodzinski per 22R PG 83.

John & Kimberly Fry  
Deed OR 247 PG 606

1315.00'      1245.00'      58.21'      11.87'

NE CORNER, S 1/2,  
SE 1/4, SECTION 17

**39.453 ACRES**  
EXISTING BUILDINGS

APPROX & ST JOSEPH RIVER

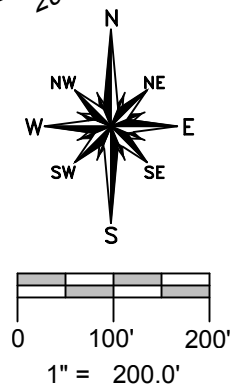

N 1°07'21" E 670.49'(M) 671.00'(PS)

N 1°14'58" E

Thomas J Taggart  
Deed OR 189 PG 951

State of Ohio DNR  
Deed OR 186 PG 210

**SURVEYED FOR:**  
Lyn B. Houk  
Deed OR 217 PG 1780

Rita M. Stahlert  
Deed Vol 315 PG 34

David E. & Jean L. Tilly  
Vol 312 PG 206 & 308

State of Ohio DNR  
Deed OR 186 PG 210

- REFERENCE SURVEYS**
- Volume 8R Page 186
  - Volume 8R Page 281
  - Volume 16R Page 240
  - Volume 17R Page 66
  - Volume 22R Page 36
  - Volume 22R Page 60
  - Volume 22R Page 83
  - Volume 22R Page 334
  - Volume 24R Page 46
  - Volume 25R Page 319

APPROX & COUNTY ROAD J

**TANGENT TABLE**

A - S 20°21'05" W	54.65'
B - S 53°11'12" W	126.44'
C - S 50°12'33" W	133.54'
D - S 27°30'07" W	169.86'
E - S 16°00'47" W	195.33'
F - S 4°57'15" W	22.04'
G - N 82°48'22" W	117.25'

**GENERAL OCCUPATION NOTE:**  
No fences were located in the field. The East line of occupation was the centerline of a River, South and West boundaries were roadway and the Northern boundary was agricultural and wooded.

SE CORNER,  
SECTION 17  
DRILLED HOLE

SW COR, SE 1/4,  
SECTION 17\*

\* Used capped Iron Pin (Basselman)  
found Iron Pipe 3.98'W & 1.06'S of Pin

- SURVEY LEGEND**
- Placed 5/8" Rebar w/ Cap
  - X Found PK Nail
  - Point Established this Survey
  - Found Iron Pin or Pipe
  - ▣ Found Monument Box
  - ⊗ Found Railroad Spike
  - X Placed MAG Nail

I HEREBY CERTIFY THAT I HAVE SURVEYED THE PREMISES SHOWN ON THE PLAT ABOVE. ALL DIMENSIONS ARE SHOWN IN FEET AND DECIMALS THEREOF. SINCE THIS SURVEY DOES NOT INCLUDE A TITLE SEARCH, THERE COULD BE EASEMENTS OR OTHER ENCUMBRANCES UPON THE LAND WHICH ARE NOT SHOWN ON THIS SURVEY PLAT. IF THESE ARE REQUIRED, PLEASE FURNISH THE NECESSARY INFORMATION. THE BEARINGS AND DISTANCES SHOWN ON THE PLAT ABOVE ARE BASED ON STATE PLANE COORDINATES, SPC83, ZONE-OHIO NORTH. THIS SURVEY HAS BEEN RECORDED IN VOL. 26R PAGE 305 OF THE WILLIAMS COUNTY SURVEY RECORDS.

Brian M. Wieland  
BRIAN M. WIELAND - REGISTERED SURVEYOR NO. 8286

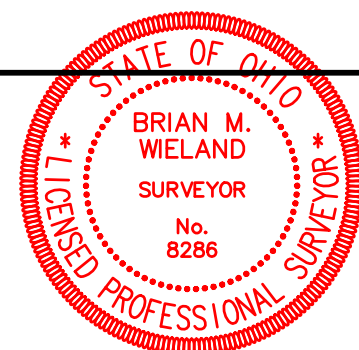

DATE: 10-22-16      JOB: 16-120

**WIELAND SURVEYING & ENGINEERING, LLC**  
14067 COUNTY ROAD 20  
WEST UNITY, OH 43570  
419-924-2100 VOICE  
419-924-5390 FAX